

**1 BUILDING SECTION**  
SCALE: 1/4" = 1'-0"

PROVIDE TREADS WHERE SHOWN, CONSISTING OF SINGLE PIECE UNITS FOR WIDTH OF STAIR TREADS OR EQUAL LENGTH UNITS IF TREAD WIDTH EXCEEDS AVAILABLE MANUFACTURED LENGTHS.  
PROVIDE RUBBER OR VINYL STAIR TREAD UNITS COMPLYING WITH FS-RR-T-650, CLASS 1, SANDED BACK, STYLE AS INDICATED. MAXIMUM FLAME SPREAD 25.

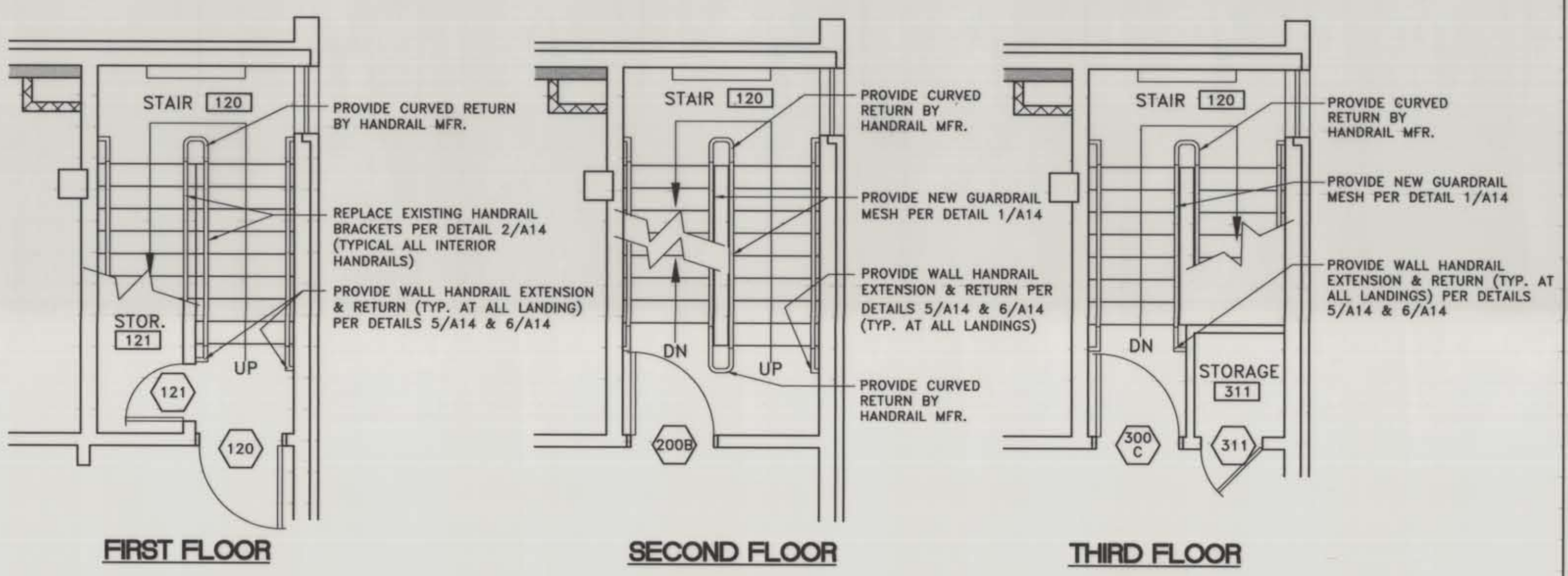

**3 PLAN - STAIR 120**  
SCALE: 1/4" = 1'-0"

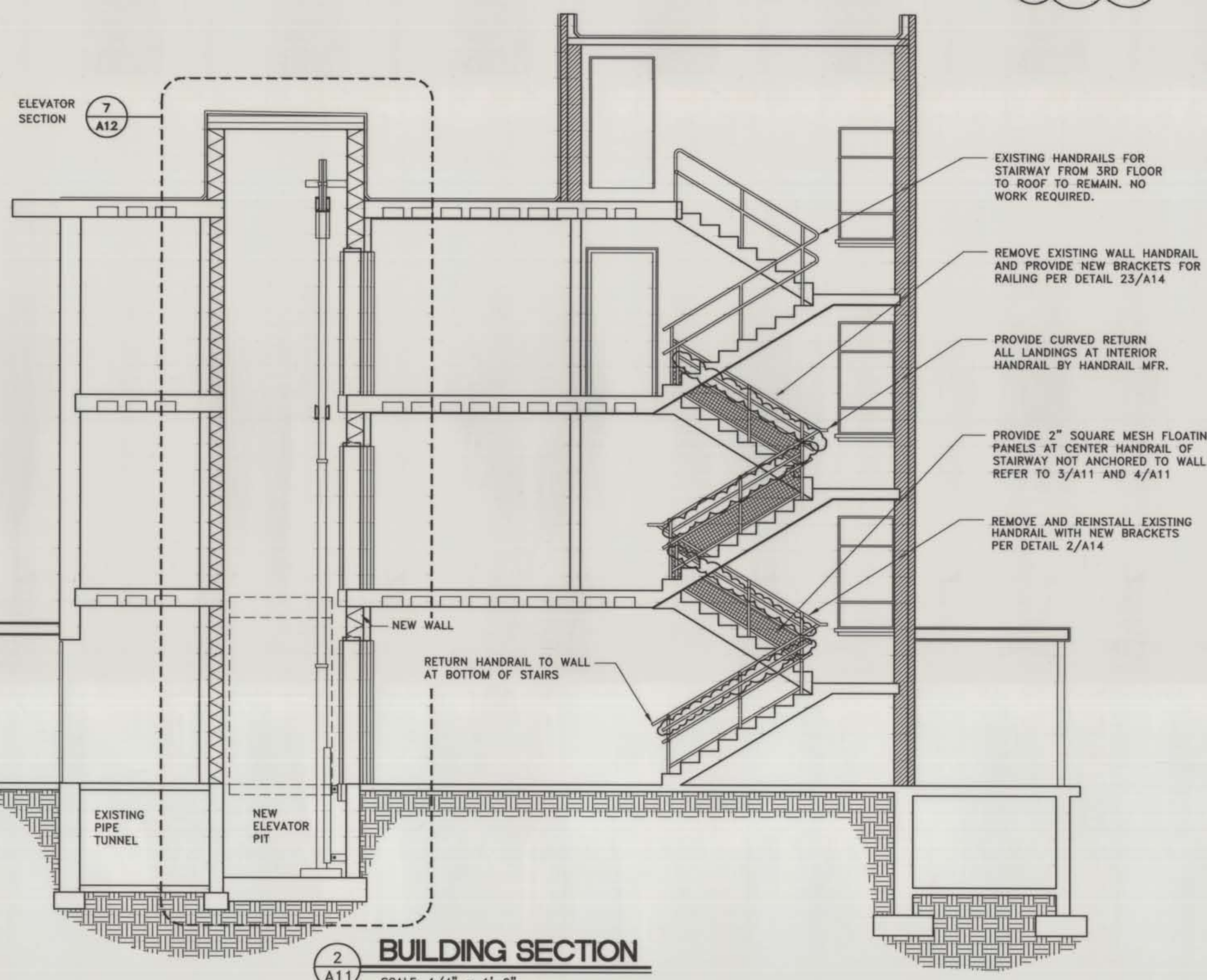

**2 BUILDING SECTION**  
SCALE: 1/4" = 1'-0"

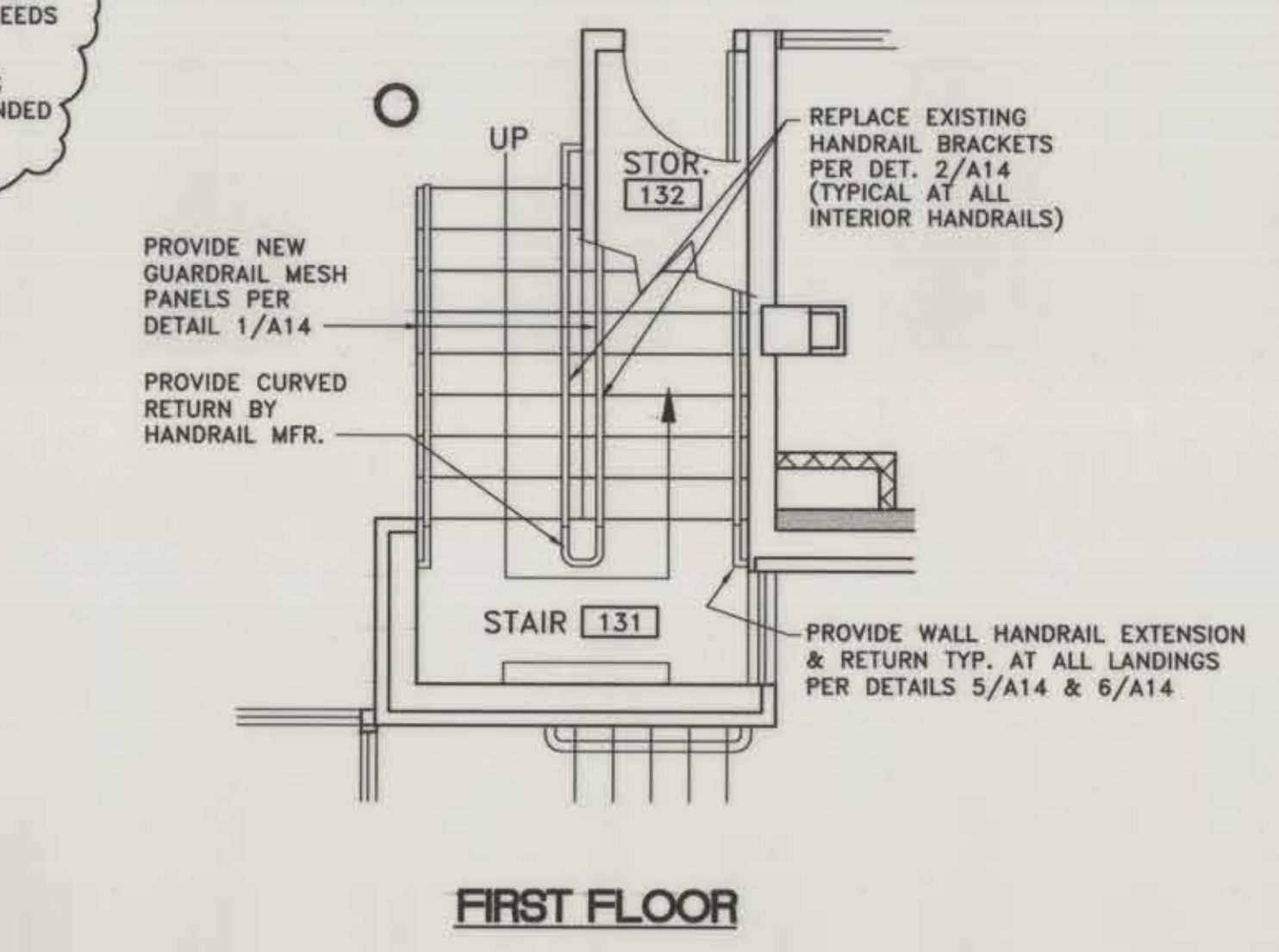

**FIRST FLOOR**

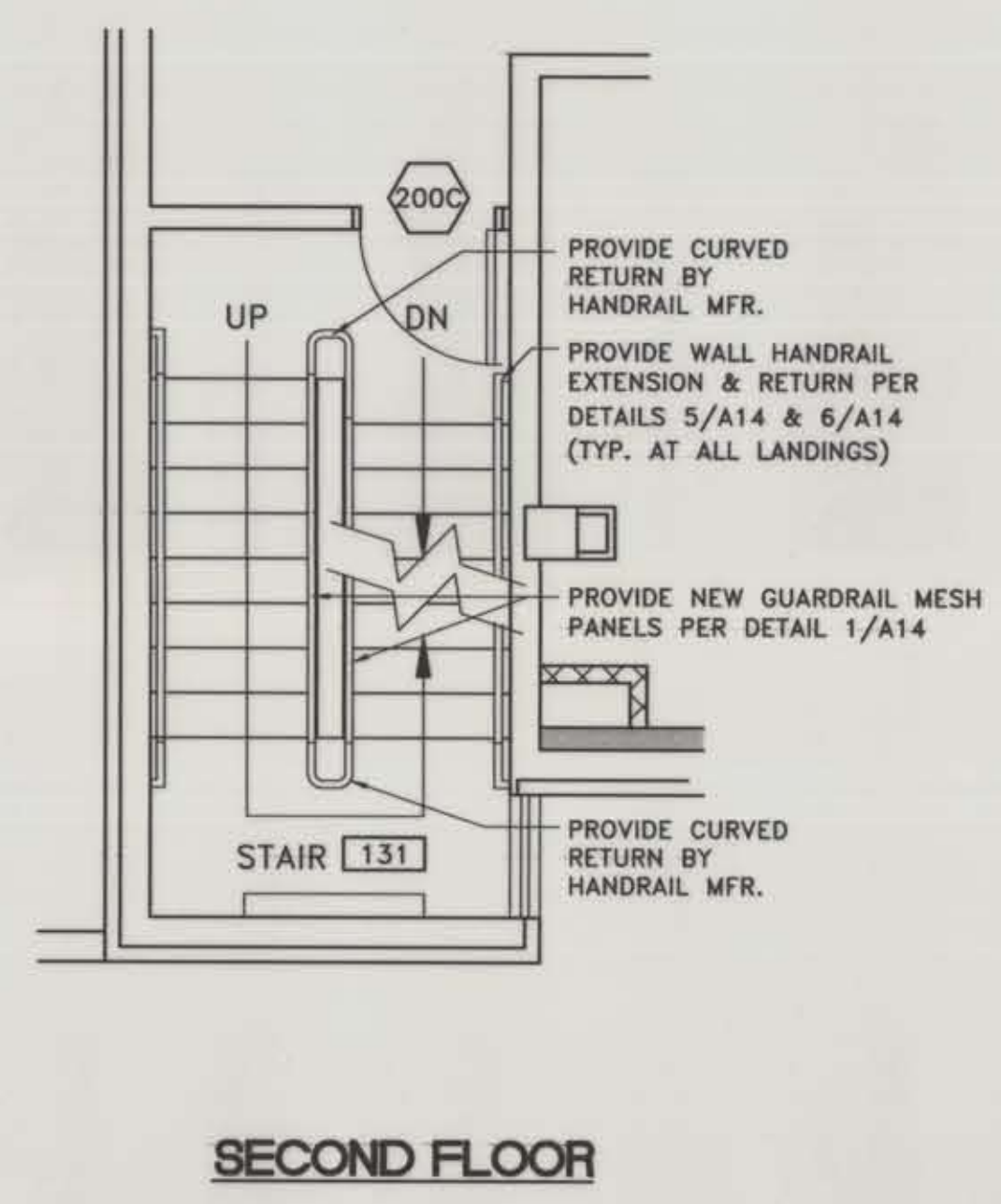

**SECOND FLOOR**

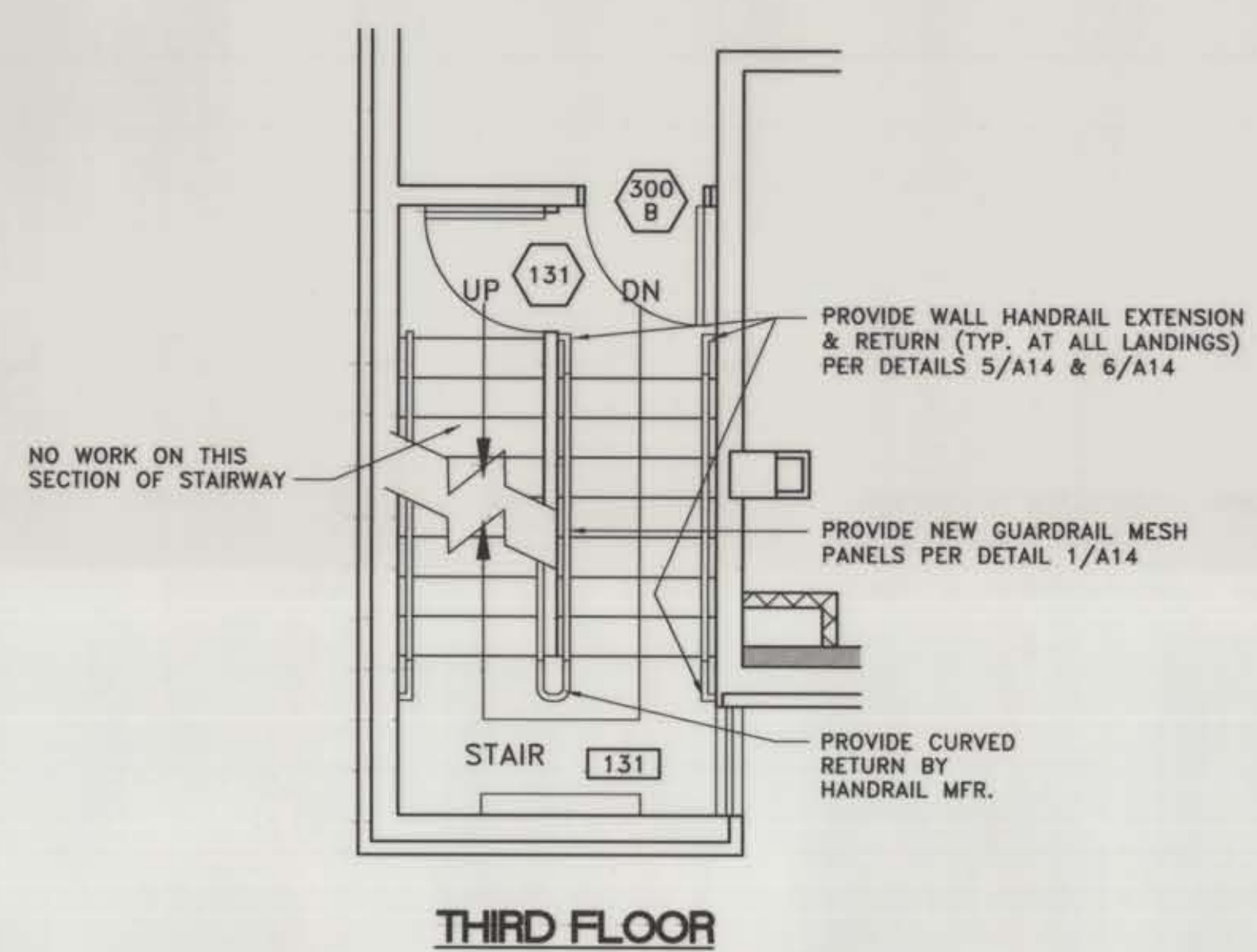

**THIRD FLOOR**

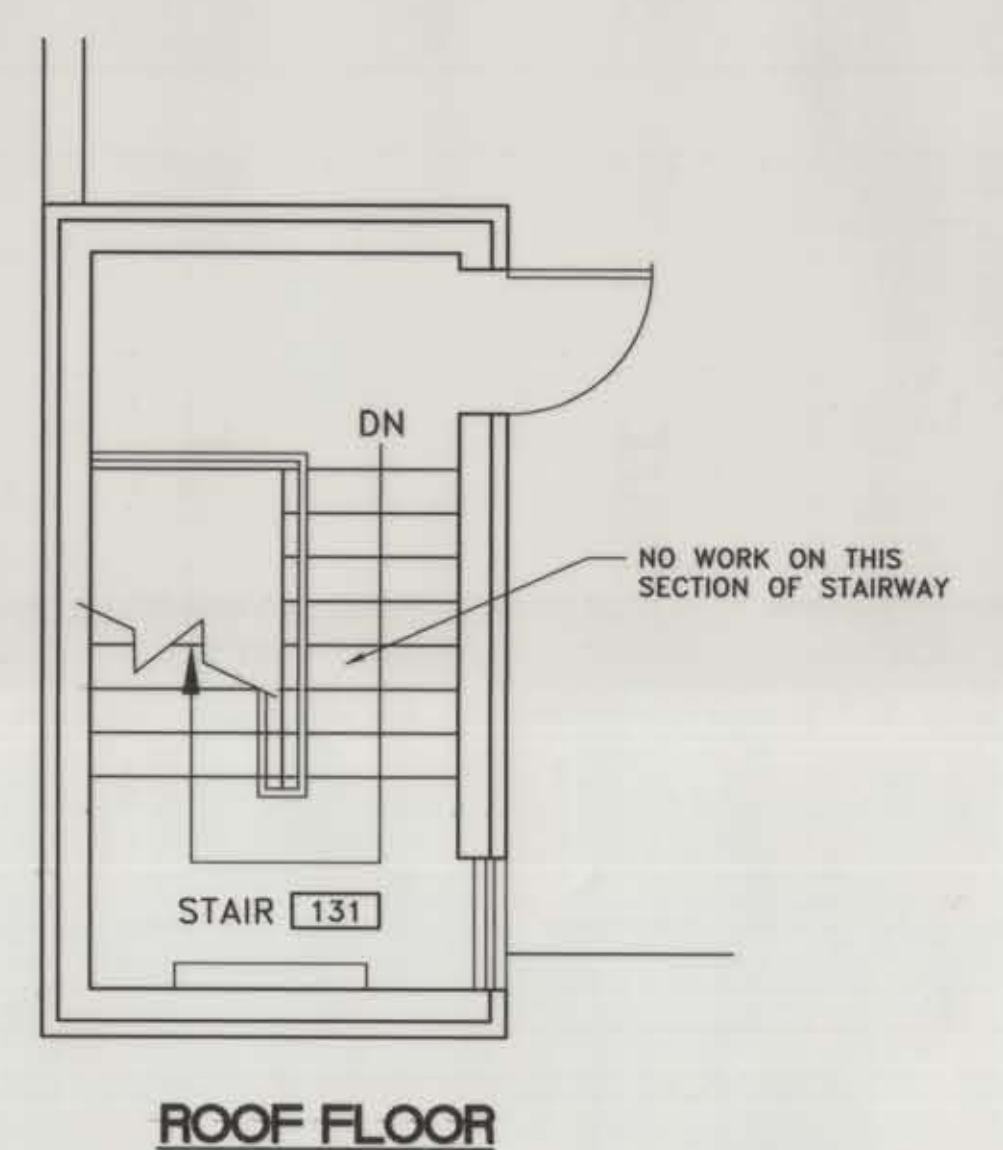

**ROOF FLOOR**

**4 PLAN - STAIR 131**  
SCALE: 1/4" = 1'-0"



644 Grand Avenue  
Billings, Montana 59101  
406-246-6383

**JGA**  
ARCHITECTS  
ENGINEERS  
PLANNERS

RENOVATION OF APSARUKE HALL  
MSU-BILLINGS  
BILLINGS, MONTANA

JOB NO. 9504  
DRAWN BY MJH/REC/JEO  
CHECKED TS  
DATE 11-3-95  
REVISED 12-4-96

SCALE: 1/4" = 1'-0"

AS BUILT DRAWING

A11

C:\jga\CAD\9504\9504-a11.dwg 18' 08' 14' 55' 1995 JGA ARCHITECTS BILLINGS, MT