

2023 - 2024

INTERNATIONAL HOUSING & RESIDENCE LIFE GUIDE

Apply for on campus housing at: msubillings.edu/reslife

PRIORITY APPLICATION FOR ROOM SELECTION IS MAY 1



MONTANA
STATE UNIVERSITY
BILLINGS





We are very excited you have chosen to attend MSU Billings. We strongly encourage all students to consider living on campus. It's a great way to get connected and make global friends.

If you have any questions, please contact the Office of Housing & Residence Life Monday-Friday between 8 a.m. and 5 p.m. United States Mountain Standard Time or send us an e-mail.

(001) 406-657-2333 • housing@msubillings.edu

CONVENIENCE

Living on campus will put you in the center of student life and academics. Trust us, it's an experience you won't want to miss. Your time and energy should go towards your school work and extracurricular activities, not towards commuting, monthly bills, and grocery shopping. Living in the residence halls isn't just a place to stay, but it is your all access pass to the resources you'll need to succeed.

THE ON CAMPUS EXPERIENCE

Wi-Fi Service

Hard wired and wireless high speed internet service in each room along with the common areas on the floors and the main lobby.

Computer Lab

Each residence hall has a computer lab with free printing and a dedicated space for studying.

Laundry

Use your U-Card or quarters to use washing machines and dryers located on each floor. Vending machines can also be found in each laundry room.

Lounge Area

Each floor has a lounge area with couches, chairs, a table, outdoor balcony, and a television with cable.

Kitchenette

Feel like cooking? Each floor has a kitchen including a sink, microwave, stove, and oven for meal prepping.

Bath and Shower

A full restroom and shower facility with private stalls placed on each wing of every floor.

Adjustable Bed

Rooms are furnished with an adjustable bed that lifts 33¾ inches off the ground for prime storage space.

Ice Machines

Ice machines available in the main lobbies of each hall.

Parking

Parking available to students with easy and quick access to each residence hall.

Housing During Breaks

Housing during the winter and summer breaks is available to students. Though residence halls officially close during those times, students can stay for a fee. The Residence Halls remain open during Thanksgiving and Spring Breaks at no additional costs. Dining Services has limited options during all breaks.

Entertainment

MSUB students receive free entry into our student activities and events including concerts, comedians, and other live entertainment, sporting events, and art exhibits.

Employment

There are several departments on campus looking for amazing students to join their team as student employees. Billings is a large community full of economic opportunities for part-time work, internships, and volunteer experiences.

Student Organizations

We have a wide range of student organizations and clubs which include academics, arts, supportive services, student government, culture & religion, recreation, and more.



ATHLETICS

Cheer on your fellow Yellowjackets in one of the 17 NCAA Division II sports teams. We have the most sports teams in the state!

STUDENT WELLNESS

We're here to help students thrive and succeed! We provide medical care, mental health counseling, violence prevention, advocacy services and a wellness program to help you make the most of your time at MSUB. Students can utilize the Health Service just across from Petro Residence Hall Lobby.

TUTORING AND MENTORING

Located in the Student Union Building, you don't have to go outside to take advantage of our Academic Support Center. Get tutoring assistance to get you through a challenging course, take advantage of other workshops and resources, or just settle in to study.

HONORS

Our honors program provides intellectually stimulating classes and career building opportunities for those who apply. Honors Students receive special advising and mentorship throughout their education at MSU Billings.

RESIDENCE HALL ASSOCIATION (RHA)

RHA's main focus is social and educational programming for residents, providing ample opportunities for interaction and involvement.

Apply Now!

- Apply for Housing online at: www.msubillings.edu/reslife
- Select "Housing Portal - Apply Now"
- Log in to the Housing Portal using the information provided in your MSUB Acceptance email
- Apply, select a roommate and room, change your housing options, and receive updates through this Housing Portal

For questions concerning your login information or application process, call the Housing Office, Monday-Friday from 8:00am-5:00pm at 406-657-2333 or via email at: housing@msubillings.edu.



Here is who is required to live on campus:

Traditional age students less than 3 years out of high school and under 30 credits at the start of the fall semester (this includes City College students).

Here is who is automatically exempt from housing if they are under 30 credits (no exemption form is needed for the following):

- Students Over 21 Years of Age: As verified through MSUB student information systems
- Military Veteran: As verified through MSUB Student information systems
- Enrolled in 5 or fewer credits: As verified through MSUB Student Information systems
- Transfer Student: As verified through MSUB Student Information systems
- Online Student: As verified through MSUB student information systems
- Non-Degree Seeking Student: As verified through MSUB Student information systems

Contact the Housing Office if you believe you meet one of the following exemptions to the live on requirement:

- Living with Immediate Family (Legal Guardian, Parent, or Grandparent) within Yellowstone County
- Married
- Physical custody of a dependent child
- Financial Hardship
- Medical Related Condition
- Documented Disability
- Unusual Circumstances

Student Health Insurance

All Montana State University Billings students enrolled in seven or more credits are required to have some form of health insurance. A student health insurance policy is available to MSU Billings students. Before registering, students will be asked to elect or waive the student health insurance. All students are eligible for health insurance if enrolled for 7 or more credits. The waiver or election process must be completed by the 15th day of fall and spring semesters. The premiums are paid on a semester basis along with tuition and fees. Those students taking the insurance for spring semester will also be covered during the summer semester, even if they are not enrolled in summer classes.

Policy brochures are available at fee payment and as the Student Health Services Office on the 2nd floor of Petro Hall.

Full information about the Student Health Insurance plan provided by The Montana University Insurance Consortium is available at university.bcsmt.com.

If you have any questions about enrolling in coverage for other family members, such as spouse or children, you may contact Student Health Services, [406-657-2153](tel:406-657-2153).



Petro Hall (6 floors)

Student Union

- Academic Support Center
- Center for Engagement
- Game Room
- Housing & Residence Life office
- Stinger's Bistro
- Student Senate

Rimrock Hall (4 floors)

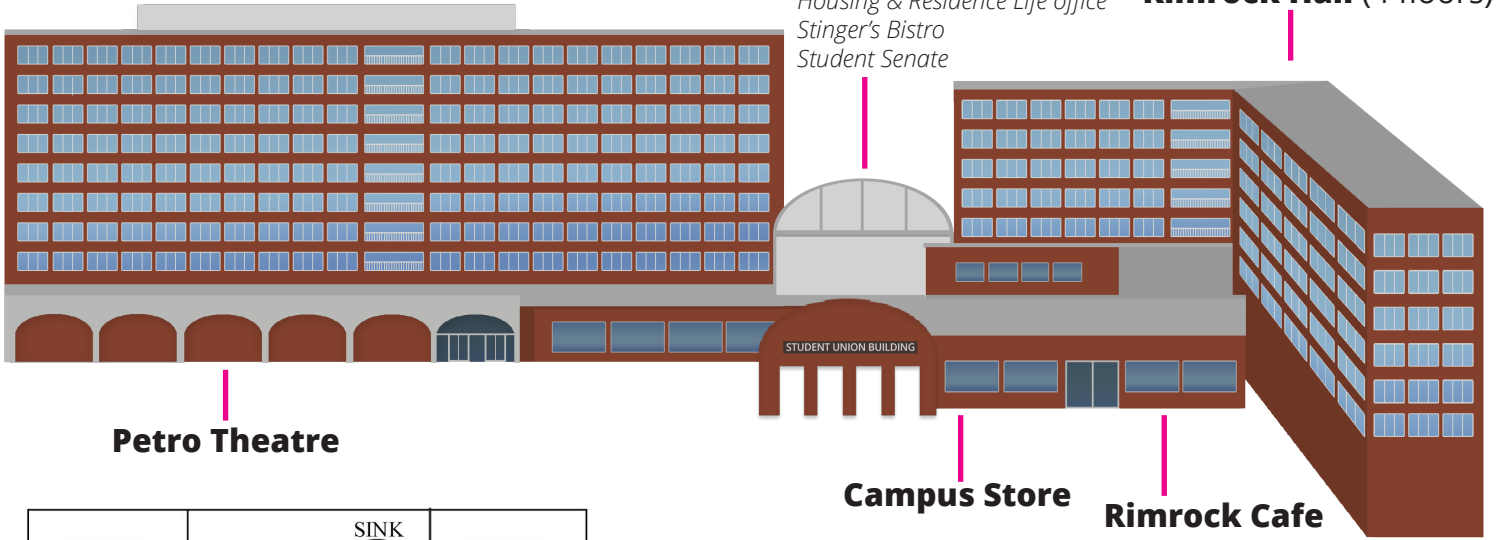

Petro Theatre

Campus Store

Rimrock Cafe

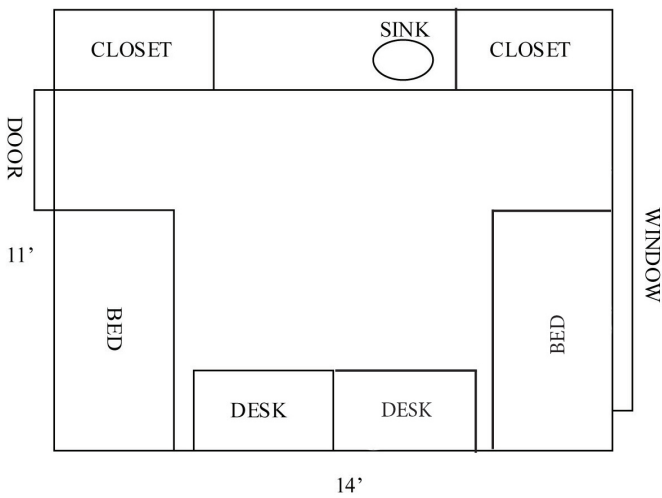

How much does living on campus cost?
 Semester Rates for 2023 - 2024
 Double room - \$2326 semester
 Single room - \$2838 semester

Rimrock Hall and Petro Hall have very similar room styles that are 11 by 14 feet. Each room includes two desks, built in shelves, two closets, a sink with a counter and mirror, curtains, wireless & hard wired internet access, and two twin adjustable beds with bunking abilities. Petro has a dedicated workout space on the main floor. Rimrock and Petro Hall have new and innovative classrooms with a study space and updated technology.



Petro Hall



Rimrock Hall



Student Union Building



Petro Hall

(6 floors)

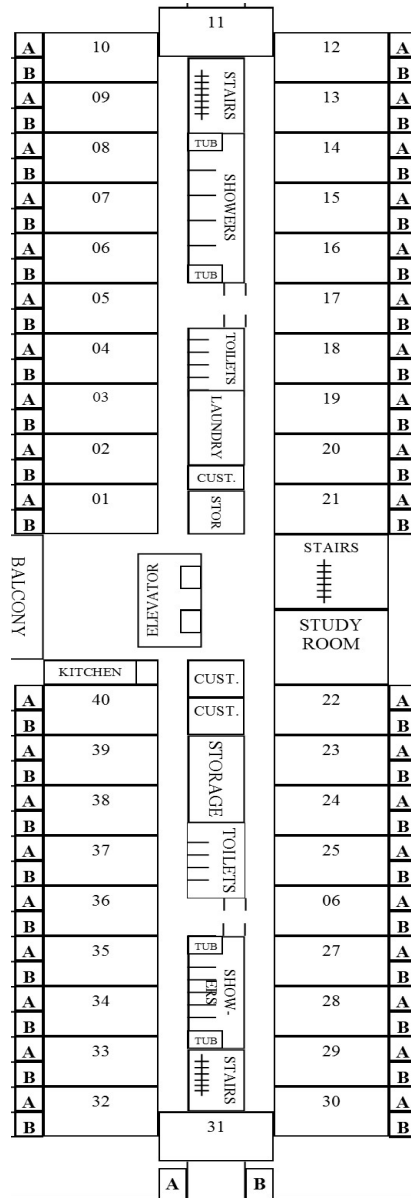

Rimrock Hall

(4 floors)

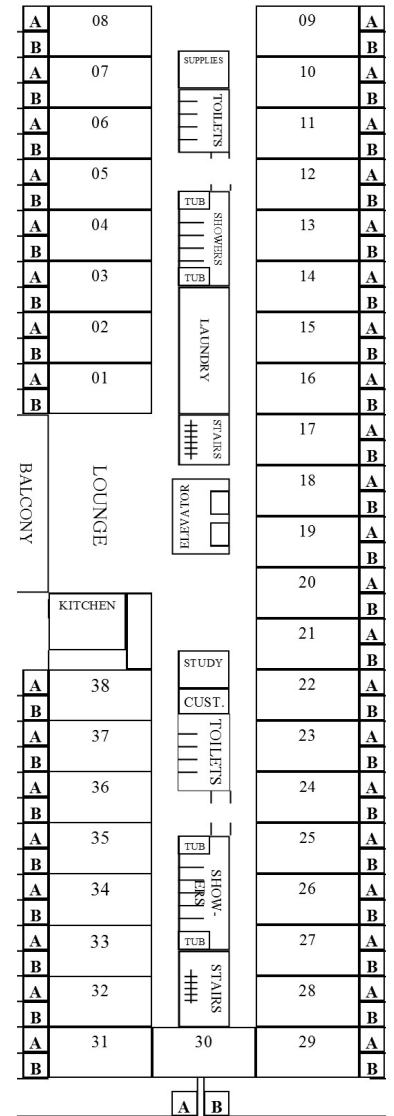

MEAL PLANS

COST PER SEMESTER 2023-2024 (Rates subject to change)

Stinger - \$2084

This plan provides 19 meals per week in our all-you-care-to-eat Rimrock Café plus \$50 in Dining Dollars.

Buzz - \$2084 Monday-Friday

This plan provides three meals per day, Monday through Friday in our all-you-care-to-eat Rimrock Café plus \$275 in Dining Dollars.

Hive - \$1944

This plan is a block meal plan, providing 160 meals per semester in our all-you-care-to-eat Rimrock Café plus \$300 in Dining Dollars.

Nest - \$1890

This plan is a block meal plan, providing 125 meals per semester in our all-you-care-to-eat Rimrock Café plus \$400 in Dining Dollars.

Dining services works to support the needs of our international students and their meal preferences.

LIVING AND DINING

What is a Block Meal Plan?

A type of meal plan that gives you a set number of meals to eat within a given semester. Students must use meals within the semester and meals will not carry over to the next semester.

What is a Meals Per Week Plan?

A type of meal plan that provides a set number of meals within a week. Students must use the defined number of meals within the given week, and the meals will not carry over to another week. The Stinger and Buzz Monday-Friday meal plans are per week plans

What are Dining Dollars?

Money put on your U-Card to use for coffee and other grab-and-go items from any MSU Billings dining location on the University and City College campus. Your dining dollar balance will carry over from the Fall to Spring semester, but needs to be used by the end of Spring semester. Dining dollars are a part of all of our residence halls meal plans.

U-Card

Your U-Card is not only your university identification, but also your lunch ticket, library card, and more. Deposit money on your card to use around campus for printing, purchasing gear at Jackets and Company Campus Store, buying food and coffee at any of the campus food service locations, and vending machines. *Students will learn how to add money to their U-Card at orientation.*

City College Dining

At City College, dining is a-la-carte, and students can select from a variety of meal options. Students can still use a meal from their plan when they eat at City College, rather than using dining dollars or paying in cash.

How do I know what meal plan is best for me?

Consider your current eating habits. Will you want three full meals per day, or will you want to grab a snack for some? Do you anticipate working in the evening? Dining Services is willing to provide a sack meal for students who might miss an evening meal. Just ask.

Double and Single Rooms

Every room is built the same that means single rooms are the same size and include everything a double room does. Single rooms are assigned based on space and availability.

Social & ResNet Fees

Every semester, students pay a \$15 Social Fee and a \$75 ResNet Fee. The \$15 Social Fee goes into the programming budget for planned events during the academic year in the residence halls. The \$75 ResNet fee goes to continued support, maintenance, and improvements for our technology and Wi-Fi service in the residence halls.



Next Steps for New International students

1. Apply for housing at msubillings.edu/reslife and pay your \$125 application fee. (Visa & Mastercard accepted. No American Express) Room assignments are available online starting in mid June. **We cannot reserve a room for students without their housing application and \$125 deposit.* www.msubillings.edu/reslife
2. Read your acceptance letter and welcome packet very carefully. It includes very important information.
3. Make travel arrangements that have you arrive in Billings by the arrival deadline located on your acceptance letter. *You are not guaranteed housing on campus prior to the arrival date specified by International Studies.*
4. Confirm with the International Studies Office your arrival time and date. Please scan and email your confirmation form to ois@msubillings.edu at least two weeks before your departure from your home country.
5. Attend New International Student Orientation. The dates for your orientation are located on your acceptance letter.
6. Be prepared to pay your bill before classes start.
7. Begin your new adventure at MSU Billings!

The use of smoking or tobacco products on any MSUB campus is strictly prohibited.



Frequently Called Numbers

- Admissions & Records: (001) 406-657-2158
- Advising & Career Services: (001) 406-657-2240
- Campus Police: (001) 406-657-2222 (emergency number)
- Cashier: (001) 406-657-1709
- Financial Aid: (001) 406-657-2188
- Housing & Residence Life: (001) 406-657-2333
- International Studies Office (001) 406-657-1705
- Campus Store (textbooks): (001) 406-657-2121
- Library: (001) 406-657-2262
- Mailroom: (001) 406-657-2241
- New Student Services: (001) 406-657-2888
- Parking: (001) 406-657-2147
- Business Services (Student Accounts): (001) 406-657-2140
- Student Health Services: (001) 406-657-2153
- Center for Engagement: (001) 406-657-2387



For more information, contact the Office of Housing & Residence Life

1-800-565-6782 ext. 2333

msubillings.edu/reslife

housing@msubillings.edu

Student Union Building, 225

Montana State University Billings | 1500 University Drive | Billings, Montana 59101-0245



Montana State University Billings has a policy of nondiscrimination in employment practices and in admissions, access to and conduct of educational programs and activities pursuant to title VII of the Civil Rights Act, Title IX of the Education Amendments, Section 504 of the Rehabilitation Act, Executive Order 11246 as amended, Vietnam era and Disabled Veterans Act, as amended, and the Montana State Human Rights Act. Any person with disabilities concerned about accessibility and/or accommodation issues should contact Disability Support Services (406) 657-2283.

To access the annual campus crime report, please visit: msubillings.edu/security
To access consumer information visit: msubillings.edu/finaid/Consumer_Information.htm